



### ■ Features

- UL Listed Sounder base
- Compatible to Nittan's UL Listed detectors
- Provides 4 sound patterns (Continuous, March, ANSI 3 temporal, ANSI 4 temporal)
- Over 85 dB at 10 feet away
- Address programed by EVA-AD2 programmer
- Contains a locking screw for tamper protection
- Reduces wiring cost

### ■ Description

EVA-S6 Base is a detector base with sounder, which is individually or collectively controlled by a control panel using addressable system. The detector base has 4 sound patterns which are continuous, march, ANSI 3 temporal and 4 temporal patterns. These patterns which are used in and around buildings can be selected by a control panel. The sound pressure level at 10 feet from the base is over 85 dB. Up to 127 bases can be connected to a loop of the control panel. The base is designed to be mounted to 3-1/2" octagonal, 4" octagonal or 4" square electrical box.

### Dimensions

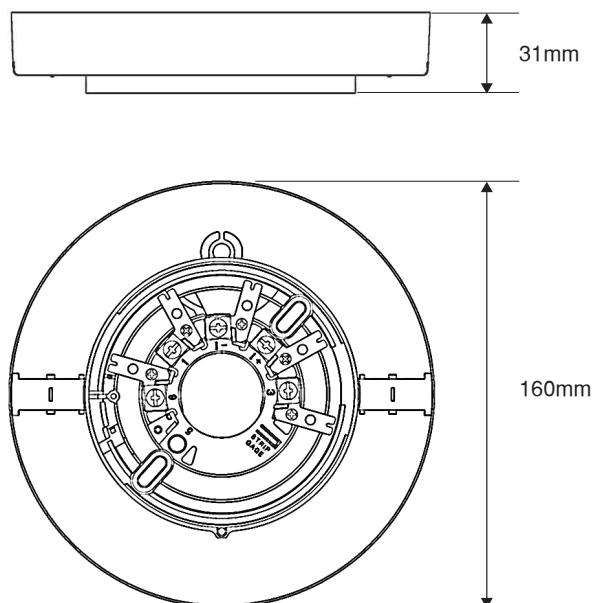

### Compatible Detector Models

Model	Discription
EVA-PY	Addressable Photoelectric Smoke Detector
EVA-PYH	Addressable Multisensory Detector
EVA-H2	Addressable Heat Detector
EVA-DPH	Addressable Dual Optical / Heat Detector



## ■ Installation Diagrams

### Analog addressable wiring

Where connected to analog detectors such as EVA-PY, EVA-PYH, EVA-H2, EVA-DPH, etc.

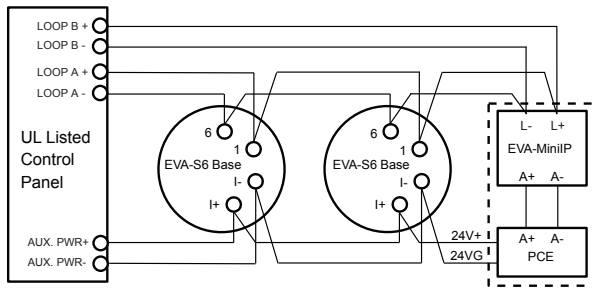

If the AUX. supply circuit needs to be monitored to detect short circuit or open circuit, connect PCE (End-of-line supervision module) to the end of the AUX. supply circuit and EVA-MiniIP to SLC.

### Mounting

EVA-S6 Base can be mounted to 4" square, 4" octagonal, or 3-1/2" octagonal electrical box.

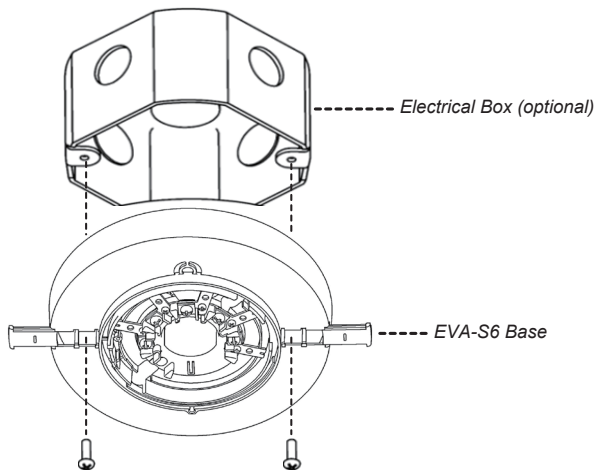

### Terminals

EVA-S6 Base is supplied with 5 terminals (include 1 unused) as follows:

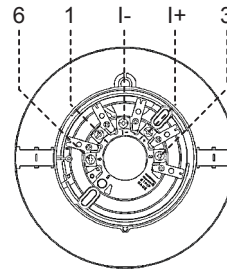

#### Terminals

- Terminal 6 = SLC -
- Terminal 1 = SLC +
- Terminal I- = AUX -
- Terminal I+ = AUX +
- Terminal 3 = UNUSED

### Locking Screw

EVA-S6 Base contains a locking screw to avoid unauthorized removal of detectors.

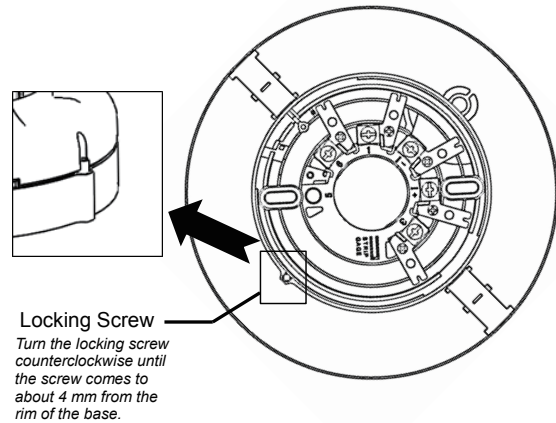

**Locking Screw**  
Turn the locking screw counter-clockwise until the screw comes to about 4 mm from the rim of the base.

## ■ Specifications

Specifications	EVA-S6 Base
SLC Applied Voltage	Rated Range 20 VDC to 38 VDC
AUX. Supply Voltage	Rated Range 16 VDC to 33 VDC
SLC Current Consumption	Standby: 0.5 mA    Alarm: 1.4 mA
AUX. Supply Current Consumption	Standby: 0.5 mA    Alarm: 20 mA
Sound pressure level	≥ 85 dB @ 10 feet away
Maximum quantity per loop	127 units
Operating Temperature	-10°C to +55°C (14°F to 131°F)
Storage Temperature	-20°C to +60°C (-4°F to 140°F)
Relative Humidity	≤ RH 95 % non-condensing
Environment	Indoor dry use only
Terminal	AWG12-20
Dimensions	φ 160 mm x H 31 mm
Weight	170 g
Standard	UL268 and UL464

Distributed By

All specifications are subject to change without any notice.  
For more information, contact with NITTAN.

**NITTAN**

Nittan Europe Ltd, Hipley Street  
Old Woking, Surrey, GU22 9LQ UK  
TEL: +44 1483 769555 FAX: +44 1483 756686